

SPRING OF 2020 DELIVERY

Wheaton Town Square



For Lease

An excellent retail opportunity in new development

- 11,337 s.f. available, divisible from 831 - 11,337 s.f.
- Steps away from the Wheaton Metro Station (3,774 RPD)
- Close proximity to Westfield Wheaton Mall
- Located in a new 308,000 s.f. Montgomery County occupied building
- Tremendous visibility and traffic from Georgia Ave (40,513 VPD) and Veirs Mill Rd (21,260 VPD)

11219 Grandview Ave
Wheaton, MD

Andy Corno

O: +1 202 719 6137

M: +1 301 520 2620

andy.corno@am.jll.com

Thomas Jackman

O: +1 202 719 5624

M: +1 301 580 1512

thomas.jackman@am.jll.com



Wheaton MD by the numbers



Demographics from subject site

	1 mi	3 mi	5 mi
Population	25,365	166,368	469,851
Average HH Income	\$109,103	\$119,802	\$124,141
Households	8,712	57,147	177,505
Employees	9,438	48,363	289,408
Businesses	973	4,451	16,810

11219 Grandview Ave

DISCLAIMER @ 2017 Jones Lang LaSalle IP, Inc. All rights reserved. All information contained herein is from sources deemed reliable; however, no representation or warranty is made to the accuracy thereof.

The space

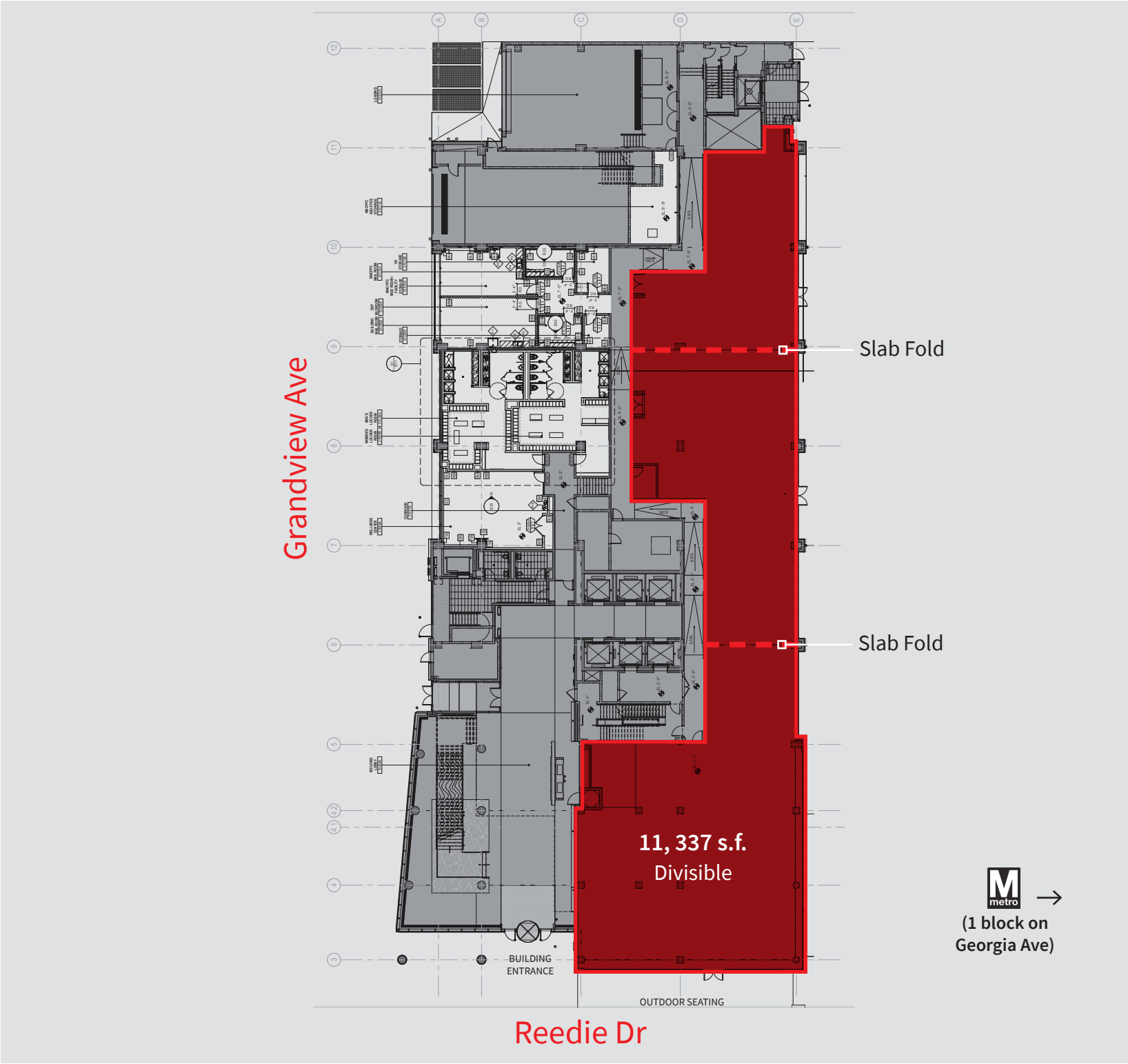

For more information,
please contact:

Andy Corno
O: +1 202 719 6137
M: +1 301 520 2620
andy.corno@am.jll.com

Thomas Jackman
O: +1 202 719 5624
M: +1 301 580 1512
thomas.jackman@am.jll.com



DISCLAIMER @ 2017 Jones Lang LaSalle IP, Inc. All rights reserved. All information contained herein is from sources deemed reliable; however, no representation or warranty is made to the accuracy thereof.